

# LEOPARD 40 SPECIAL OFFER - MIAMI 2015



## Leopard 40 #101 \$439,000

Leopard Catamarans excitedly announces the new Leopard 40. This catamaran, currently in production, is a product of South African boat builders Robertson and Caine and includes a unique, modern design thanks to experienced naval architects Simonis and Voogd. She resembles her predecessors in speed, agility, and blue-water performance, but her enhancements include an increased volume in the hulls, allowing for additional interior space, and an innovative interior layout.

Must be made available for the Miami Boat Show - February 25, 2015  
Sale price includes options on back.

2013 Base Price:	\$349,000
Additional Options:	\$137,300
Total Price:	\$486,300
Discount:	\$47,300
Boat Show Special:	\$439,000*

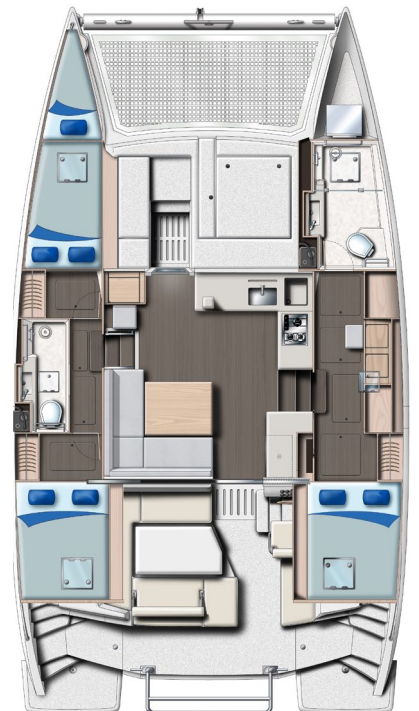

Phone: 1-954-925-8050

info@leopardcatamarans.com | www.leopardcatamarans.com

# \$439,000

# LEOPARD

# 40 #101

L.O.A.:	39 Ft. 4 In.	Cabins:	3	Water:	206 Gal.
L.W.L.:	38 Ft. 1 In.	Heads:	2	Sail:	1032 Sq. Ft.
Beam:	22 Ft. 1 In.	Engines x 2:	29 HP	Mast:	63 Ft. 10 In.
Draft:	3 Ft. 10 In.	Fuel:	95 Gal.	Displacement:	30,203 Lbs.

## Upgrades Included in Price:

### INTERIOR

Upholstery - Pack1 - Standard - Faux-Leather "Milk" (Light)  
1 Forepeak child berth for 3-Cabin Layout, including mattress (1)  
Interior saloon blinds - front & side windows

### ENGINES & DRIVE

Yanmar 3YMAE 29hp Engines with sail drives in lieu of std engines (2) - Standard

### NAVIGATION & ELECTRONICS

Fusion 700i Series Marine Stereo in saloon with docking station. Includes Bluetooth, USB, & AUX connectivity. Fusion Marine speakers in saloon (2) & aft cockpit (2). Wired remote control at helm station (1) - Note: Raymarine MDFs (not included in option) & personal wireless devices (only if connected wirelessly to Raymarine MFD via the Raymarine APP) can control system.  
Raymarine Base Pack: Includes Ray55 VHF (US-CARIB) at Switchpanel & additional VHF handset at helm. p70 color autopilot display, a95 9" Multifunction display with WiFi and i70 Colour instrument at Helmstation. With retractable depth & speed, plus wind transducers.

### ELECTRICAL

110v Shore Power Pack: 2 heavy duty 50ft 30amp shore powerlines, AC switch panel, AC outlets in cabins, galley, at freezer & switch panel  
Battery charger 60amp  
Shaver outlets in heads, 110 volt with GFI protection (2) (only for boats with 110 volt systems, option L40-4100)  
Upgrade std Lead Acid house and engine batteries to AGM batteries  
One additional AGM house battery (210 Ahr) - House battery note: A maximum of one additional house battery can be added on the L40; i.e. max three house batteries in total  
Ventilation fans in saloon (2) & cabins (3) for Three Cabin Layout - (5) total  
Double USB socket in cabins – 3 Cabin layout  
Provision for genset (includes fuel supply, exhaust system with through hull fittings and cooling water system, but excludes genset unit, wiring, battery and genset control panel).  
Air conditioning System (2) 16,000 BTU 110v  
Winch: Electric Sheet winch (in lieu of outboard primary winch) (1)  
Provision for TV in Saloon - Swing Bracket & AC Outlet  
Solar panels 70 watt each fitted to hard top (2)  
Underwater Lights - 4 x Blue mounted in stern

### PLUMBING

Electric flushing toilets: Jabsco quiet flush (seawater option) in lieu of standard toilets (2)  
Stern shower: Hot/cold water in lieu of cold only

### HEATING, REFRIGERATION & GAS

LPG gas outlet on stern rail for optional BBQ

### DECK AND HULL

Exterior - Pack1 - "Standard"  
Coach roof side window removable shade covers  
Leather covered steering wheel  
Custom stainless steel davit system with tackle complete with electric winch

### SAILS & RIGGING

Stackpack as per exterior pack choice  
Bowsprit complete with roller furler and Code 0  
Square Top mainsail in lieu of standard main

### GENERAL EQUIPMENT

45lb (20kg) Delta anchor complete with 165ft (50m) chain  
Anchor bridle, shackles and hook  
Fenders (6), mooring lines (4, 16mm x 10m), spring lines (2, 16mm x 15m)

### COMMISSIONING

Transport, documentation and commissioning package: includes anti-fouling paint, transport to Cape Town harbor, launching and stepping of mast, installation of sails and rigging commissioning of equipment and sea trials, 3 days marina fees at Royal Cape Yacht Club  
USCG Safety Package including 8 man life raft, U-bolts and tie downs  
Post delivery commissioning  
Freight Delivery \*

\*In-water delivery requires electronics and safety equipment (including life-raft) - Freight is an estimation only and can be a combination of freighter + water delivery  
Prices, standard equipment and options are subject to change without notice - All Sales are subject to signed Purchase & Sales Agreement and Deposit